



Crabtree, Rohrbaugh & Associates - Architects

401 East Winding Hill Road
Mechanicsburg, PA 17055
Maryland • Pennsylvania • Virginia • West Virginia

Contractor: eciConstruction
Address: 124 West Church St
Address: 0
City, State, ZIP: Dillsburg, PA 17019

Project : Renos & Additions to Northern
Address: Lebanon Middle & High School

Change Order No: 8

Date: 5/23/2024

Architect's Project No: 3624

The contract is changed as follows:

Contract Type: General

Notice to Proceed Date: 12/8/2023

Add \$	24,732.00
Deduct	

To provide additional grading in order to keep the existing fiber ductbank in place per Steckbeck sketch/email dated 3-27-24. This cost will be offset by the credit offered by the EC. See the attached ECI PCO-05R dated May 22, 2024.

Additional Documentation Attached

This Change Order is not valid until signed by the Owner, Architect, and Contractor.

Original Contract Amount	\$	19,612,900.00
Net Change by previous Change Orders	\$	34,046.00
Contract Amount prior to this Change Order	\$	19,646,946.00
Net Change by this Change Order	\$	24,732.00
Contract Amount after this Change Order	\$	19,671,678.00

Contract Time adjustment as a result of this Change Order 0 Days
Date of Substantial Completion as of this Change Order

Architect

Crabtree Rohrbaugh & Assoc.
401 East Winding Hill Road
Third Floor
Mechanicsburg, PA 17055

Contractor

eciConstruction
124 West Church St
0
Dillsburg, PA 17019

Owner

Northern Lebanon SD
345 School Drive
0
Fredricksburg, PA 17026

By: _____

By: _____

By: _____

Date: _____

Date: _____

Date: _____



Pending Change Order: 5

Infiltration Basin 2 Grading

Submission Date: 5/8/2024

Owner : Northern Lebanon School District
345 School Drive
Fredericksburg, PA 17026

Project: 23050. / Northern Lebanon MSHS Additions & Renov
345 School Drive
Fredericksburg, PA 17026

Scope of Work: Provide revised grading per sketches in 3-27-24 email from Steckbeck including export of additional material and stabilization.

REVISEDMay 22, 2024 - Revised Garland Construction Pricing

Description	Est Units	UM	Unit Cost	Est Hrs	Hrs Cost	Estimated Cost
Infiltration Basin 2 Grading						
Foerman/Layout	0.00	HRS	0.00	2.00	81.00	162.00
Garland Construction	0.00	LS	0.00	0.00	0.00	21,324.00
JPH	0.00	LS	0.00	0.00	0.00	1,600.00
				Subtotal Item	1	23,086.00

Cost Type Recap:	Amount
1 Labor	162.00
4 Subcontract	22,924.00
Subtotal Item	23,086.00
OH&P - Labor	16.00%
OH&P - Sub	6.00%
Bond	1.00%
Requested Total For Item	1
	24,732.00
Total For Change Order	24,732.00

As per discussion at the 5-22-24 job meeting, this PCO is accepted as this cost will be offset by EC credit to keep existing fiber ductbank. Formal CO will be prepared.
BK 5-23-24

At this time eciConstruction is not requesting a time extension as a result of this change proposal. If at a later date, it is determined this change to the work has extended the contract duration eciConstruction reserves the right to seek compensation for extension of time.

If you have questions please call me at 717-638-3000.

Approved By: Northern Lebanon School District

Submitted By: eciConstruction, LLC

Signed: _____

Signed:  _____

By: _____

By: Dan Shaffer

Date: _____

Date: 5/8/2024

SCALE: 1" = 40'

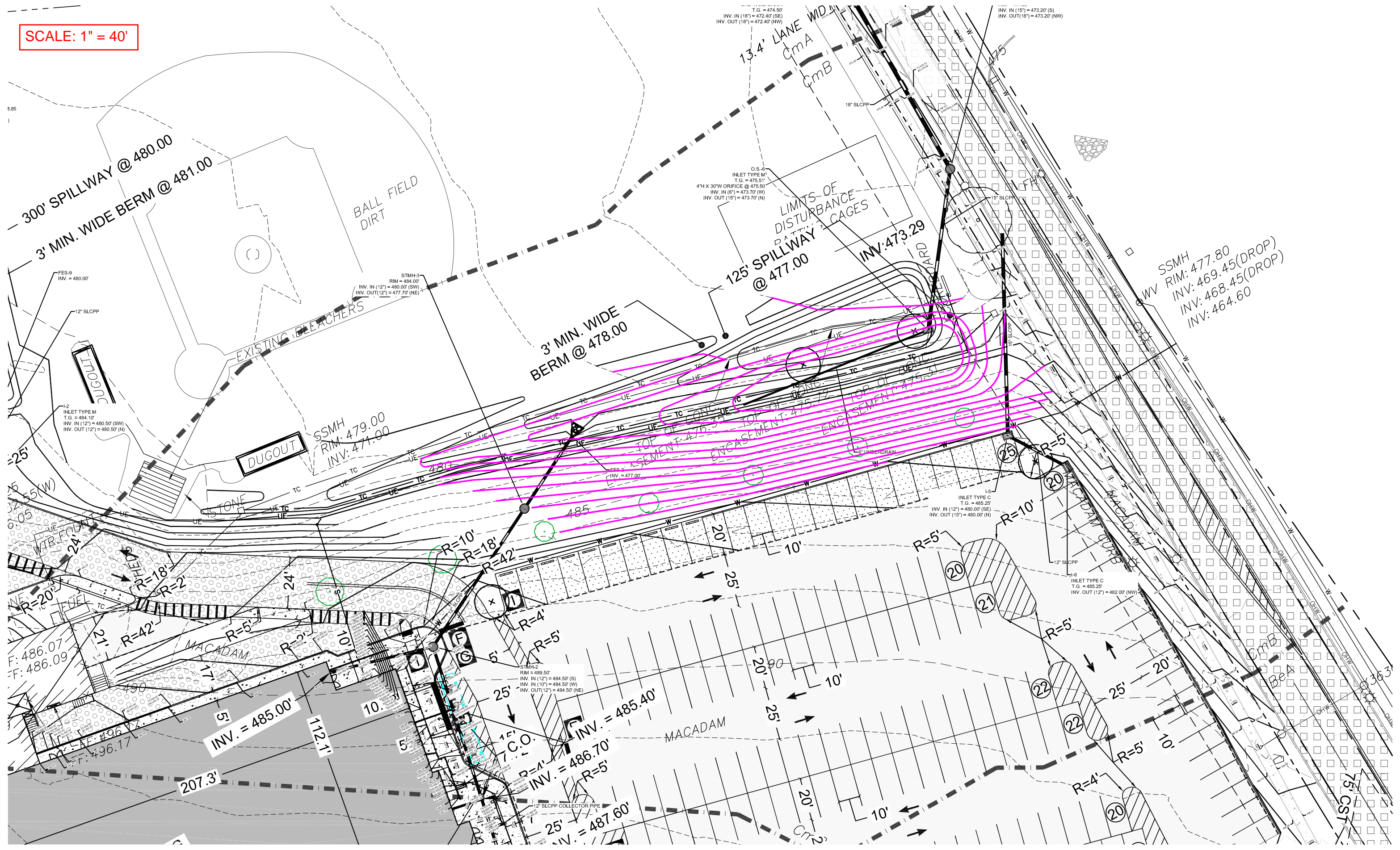

SSMH
 RM: 477.80
 INV: 469.45(DROP)
 INV: 468.45(DROP)
 INV: 464.60

T.G. = 474.50'
 INV. IN (18") = 472.40' (SE)
 INV. OUT (18") = 472.40' (NW)

O.S.-6
 INLET TYPE M
 T.G. = 475.51'
 4" X 30" W ORIFICE @ 475.50'
 INV. IN (6") = 473.70' (W)
 INV. OUT (15") = 473.70' (N)

1-5
 INLET TYPE C
 T.G. = 485.25'
 INV. IN (12") = 480.00' (SE)
 INV. OUT (15") = 480.00' (N)

1-6
 INLET TYPE C
 T.G. = 485.25'
 INV. OUT (12") = 482.00' (NW)

STMH2
 RIM = 489.50'
 INV. IN (12") = 484.50' (S)
 INV. IN (10") = 484.50' (W)
 INV. OUT (12") = 484.50' (NE)

INV. = 485.00'

INV. = 485.40'

INV. = 486.70'

INV. = 487.60'

9.85

7.5 CST

Dan Shaffer

From: Mike Lusaitis <mlusaitis@steckbeck.net>
Sent: Wednesday, March 27, 2024 1:58 PM
To: Dan Shaffer
Cc: Brian Kilgus; Bradly W. Reist; Gary R. Messinger; Andrew Nolt; Dave Finnegan; Brenda Santiago; Leland Leahy; Sean R. Douty
Subject: FW: NLHS Renovations - Location of Communications Duct Bank and Scoreboard Electric Feed
Attachments: PBASE_INF BASIN 2 REVISION Model (1).pdf

Good afternoon Dan – Please see below and attached for the sketch depicting the proposed location shift for Infiltration Basin 2, showing the basin bottom slid to the south by approximately 20 feet. I would expect to simply extend the outlet pipe to the new basin location, holding the same pipe inverts, which will lead to approximately 20 additional feet of pipe.

For this change, we may also need to add some erosion control matting for the 140' +/- of steep slopes that are generated by the basin shift.

I am hopeful this will provide a decent depiction of the changes we are looking at, so you can provide a ballpark cost for the scope of this change, should the school decide to move forward. Let me know if you have any questions for me on the anticipated impacts to ECI's scope of work.

Regards,
Michael F. Lusaitis, P.E.

Steckbeck Engineering & Surveying, Inc.
279 N. Zinns Mill Road, Suite A, Lebanon, PA 17042
Phone: 717-272-7110 Ext. 105 | Fax: 717-272-7348 | mlusaitis@Steckbeck.net

From: Mike Lusaitis
Sent: Wednesday, February 28, 2024 10:57 AM
To: Brian Kilgus <bkilgus@cra-architects.com>
Cc: bmccarty@dejazzd.com; Dave Yiengst <dyiengst@steckbeck.net>; Jason Chernich <jchernich@steckbeck.net>; Bradly W. Reist <breist@norleb.k12.pa.us>; Gary R. Messinger <gmessinger@norleb.k12.pa.us>; Andrew Nolt <andrewn@mooreengineering.com>; Dave Finnegan <davef@mooreengineering.com>; Brenda Santiago <bsantiago@fidevia.com>; Leland Leahy <lleahy@fidevia.com>; Sean R. Douty <sdouty@cra-architects.com>
Subject: RE: NLHS Renovations - Location of Communications Duct Bank and Scoreboard Electric Feed

To keep everyone in the loop on this, the duct bank happens to fall directly in the middle of our proposed basin bottom for Infiltration Basin 2. Our surveyed elevations show the top of the duct bank concrete encasement extending to elevation 475.50', which extends above our proposed basin bottom elevation of 475.00'. We are left with the following two options as it relates to the existing concrete encased TC duct bank:

1. We can attempt to re-grade the basin to push the basin bottom approximately 20 feet to the south, as depicted below in magenta grade lines. This would allow us to place the basin berm (Elev. 477.00+) over the existing TC facilities, thus avoiding the need for relocation. The issue here is that we will likely be required to prepare a revised PCSM submittal together for review by the Township Engineer, and perhaps also by the Lebanon Co Conservation District. I have an email out to the Township and LCCD to determine what we would be required to do in order to implement the grading change as depicted below. As an item of note, a large portion of the existing embankment slope to the north of the student parking lot would need to be re-graded in order to avoid the relocation of the existing duct bank. From what I understand, this existing gradual slope is currently used for

seating during baseball games. We would be able to leave some of the gradual slope in-place, but we would need to transition to a :1 slope for an approximately 150-ft section of the embankment.

2. We take a look at the costs and impacts of lowering and/or relocating the existing TC facilities to the existing embankment as shown on the original plan. It would be good for us to understand these costs now, so that we can make a determination when we hear back from the Township and LCCD on the impacts of Option 1 (above).



Regards,
Michael F. Lusaitis, P.E.

Steckbeck Engineering & Surveying, Inc.
279 N. Zinns Mill Road, Suite A, Lebanon, PA 17042

Phone: 717-272-7110 Ext. 105 | Fax: 717-272-7348 | mlusaitis@steckbeck.net

From: Brian Kilgus <bkilgus@cra-architects.com>

Sent: Thursday, February 22, 2024 6:55 AM

To: Mike Lusaitis <mlusaitis@steckbeck.net>

Cc: bmccarty@dejazzd.com; Dave Yiengst <dyiengst@steckbeck.net>; Jason Chernich <jchernich@steckbeck.net>;

Bradly W. Reist <breist@norleb.k12.pa.us>; Gary R. Messinger <gmessinger@norleb.k12.pa.us>; Andrew Nolt

<andrewn@mooreengineering.com>; Dave Finnegan <davef@mooreengineering.com>; Brenda Santiago

<bsantiago@fidevia.com>; Leland Leahy <l Leahy@fidevia.com>; Sean R. Douty <sdouty@cra-architects.com>

Subject: RE: NLHS Renovations - Location of Communications Duct Bank and Scoreboard Electric Feed

Mike L.

Please advise where this stands from the info you gathered on 2-2-24.

Brian

From: Brian Kilgus

Sent: Wednesday, February 14, 2024 1:57 PM

To: Mike Lusaitis <mlusaitis@steckbeck.net>

Cc: bmccarty@dejazzd.com; Dave Yiengst <dyiengst@steckbeck.net>; Jason Chernich <jchernich@steckbeck.net>;

Bradly W. Reist <breist@norleb.k12.pa.us>; Gary R. Messinger <gmessinger@norleb.k12.pa.us>; Andrew Nolt

<andrewn@mooreengineering.com>; Dave Finnegan <davef@mooreengineering.com>; Brenda Santiago

<bsantiago@fidevia.com>; Leland Leahy <l Leahy@fidevia.com>

Subject: Re: NLHS Renovations - Location of Communications Duct Bank and Scoreboard Electric Feed

Mike

Please advise status of this issue now that you were on site and gathered location/elevation information.

Brian Kilgus

Construction Administration

Crabtree, Rohrbaugh & Associates - Architects

www.cra-architects.com

412-443-0771 (c)

717-458-0272 (o)

On Jan 31, 2024, at 5:28 PM, Mike Lusaitis <mlusaitis@steckbeck.net> wrote:

THIS EMAIL IS FROM SOMEONE OUTSIDE OF CRA ARCHITECTS.
DO NOT CLICK ON LINKS OR OPEN ATTACHMENTS UNLESS YOU ARE 100% CERTAIN OF THE ORIGINATION AND
CONTENT.

Sounds good, thank you Kyle.

Regards,

Michael F. Lusaitis, P.E.

Steckbeck Engineering & Surveying, Inc.

279 N. Zinns Mill Road, Suite A, Lebanon, PA 17042

Phone: 717-272-7110 Ext. 105 | Fax: 717-272-7348 | mlusaitis@steckbeck.net

From: bmccarty@dejazzd.com <bmccarty@dejazzd.com>

Sent: Wednesday, January 31, 2024 3:30 PM

To: Mike Lusaitis <mlusaitis@steckbeck.net>

Cc: Dave Yiengst <dyiengst@steckbeck.net>; Jason Chernich <jchernich@steckbeck.net>; 'Bradly W. Reist' <breist@norleb.k12.pa.us>; 'Gary R. Messinger' <gmessinger@norleb.k12.pa.us>; 'Andrew Nolt' <andrewn@mooreengineering.com>; 'Dave Finnegan' <davef@mooreengineering.com>; 'Brian Kilgus' <bkilgus@cra-architects.com>; 'Brenda Santiago' <bsantiago@fidevia.com>; 'Leland Leahy' <l Leahy@fidevia.com>

Subject: RE: NLHS Renovations - Location of Communications Duct Bank and Scoreboard Electric Feed

Friday morning will work 2/2/24 at 9:00am.

We will be onsite.

From: Mike Lusaitis <mlusaitis@steckbeck.net>

Sent: Wednesday, January 31, 2024 2:44 PM

To: bmccarty@dejazzd.com

Cc: Dave Yiengst <dyiengst@steckbeck.net>; Jason Chernich <jchernich@steckbeck.net>; Bradly W. Reist <breist@norleb.k12.pa.us>; Gary R. Messinger <gmessinger@norleb.k12.pa.us>; Andrew Nolt <andrewn@mooreengineering.com>; Dave Finnegan <davef@mooreengineering.com>; Brian Kilgus <bkilgus@cra-architects.com>; Brenda Santiago <bsantiago@fidevia.com>; Leland Leahy <l Leahy@fidevia.com>

Subject: NLHS Renovations - Location of Communications Duct Bank and Scoreboard Electric Feed

Good afternoon Kyle,

I am reaching out to you and copying in Dave Yiengst from our office to coordinate the timing test pitting and locating the existing duct bank and electric conduit in the area to the north of the student parking lot. We should be able to get to the site on **Friday (2/2/24) at 9:00 AM** for location of these utilities, if that works for you.

For reference, I have provided a snip below depicting the locations I would suggest for the location of the existing duct bank and conduit. I am thinking 4 location points should be sufficient for us to get a good representation on the locations and depths of each utility. If you have any issues with the proposed time or scope, please let me know.

<image001.png>

Regards,

Michael F. Lusaitis, P.E.

Professional Engineer

<image002.png>

Steckbeck Engineering & Surveying, Inc.

279 N. Zinns Mill Road, Suite A

Lebanon, PA 17042

P: 717-272-7110 ext. 105

C: 717-823-8857

F: 717-272-7348

An Employee Owned Company

Website: www.steckbeck.net

Dan Shaffer

From: John Henry <john@jphent.com>
Sent: Monday, April 1, 2024 3:42 PM
To: Dan Shaffer
Subject: Re: 23050 - FW: NLHS Renovations - Location of Communications Duct Bank and Scoreboard Electric Feed

Dan,

For JPH it looks like there will be additional erosion control matting and seeding than what was originally figured. The additional costs are below.

Materials- \$700
Labor- \$900

Total Additional Cost- \$1,600

Thanks,

On Wed, Mar 27, 2024 at 2:11 PM Dan Shaffer <Dan.Shaffer@eciconstruction.us> wrote:

Kyle and John, see attached and please review and confirm if you see this as an added cost for the extra pipe and slope stabilization? They are shifting the basin due to the existing duct bank and trying to save this.

Thanks,

Dan

Dan Shaffer | Project Manager | eciConstruction   

p: 717.638.3322 | f: 717.638.3001 | m: 717.357.8539 | a: 124 W. Church Street, Dillsburg, PA 17019

w: www.eciConstruction.us | e: dan.shaffer@eciConstruction.us

From: Mike Lusaitis <mlusaitis@steckbeck.net>
Sent: Wednesday, March 27, 2024 1:58 PM
To: Dan Shaffer <Dan.Shaffer@eciConstruction.us>
Cc: Brian Kilgus <bkilgus@cra-architects.com>; Bradly W. Reist <breist@norleb.k12.pa.us>; Gary R. Messinger <gmessinger@norleb.k12.pa.us>; Andrew Nolt <andrewn@mooreengineering.com>; Dave Finnegan <davef@mooreengineering.com>; Brenda Santiago <bsantiago@fidevia.com>; Leland Leahy

GARLAND CONSTRUCTION SERVICES, INC.

103 GLENNWORTH ROAD
POTTSVILLE PA 17901

Proposal

Proposal Date: 4/24/2024

Proposal #: 502

Project:

Bill To:

eciConstruction, LLC
124 West Church Street
Dillsburg, PA 17019

Description	Est. Hours/Qty.	Rate	Total
new pond grading change order north Lebanon hs ms additions			
strip topsoil	188	4.25	799.00
cut	1,212	3.00	3,636.00
fill	80	3.00	240.00
respread topsoil bank area	161	6.25	1,006.25
disposal soil masons dump site	1,789	8.00	14,312.00
fine grading new slope from parking lot	8,702	0.30	2,610.60
os6 to stmh 1 pipe 15"	20	36.00	720.00
Total			\$23,323.85